

TECHNICAL DATA SHEET

1500 B - C Lateral Raised

MODEL :

Brick version : 1500 B
Refractory concrete oven dome : 1500 C

MATERIALS :

Refractory brick
Refractory concrete
Reinforced with metal fibres

PARTS :

The hearthstone : 4 parts
The oven arch : 4 parts
The bricked arch

CARACTERISTICS :

Cooking chamber : 13.25 feet²
Weight : 1552 lb

POWER USED :

Pre-firing 2 hours : 23.3 lb Wood/Hour (20% dampness) = 43 kW/Hour
Cooking with the door opened : 11.7 lb Wood/Hour (20% dampness) = 21.5 kW/Hour
Power going through the sides with the advised insulation : 1.3 KW/Hour
Radiation power (through the door) : 1.9 KW/Hour
Fresh air consumption : 270 m³/Hour at 20 °C
Minimal smoke pipe : Height 3 m- Part 255 cm²-Diameter 200 mm

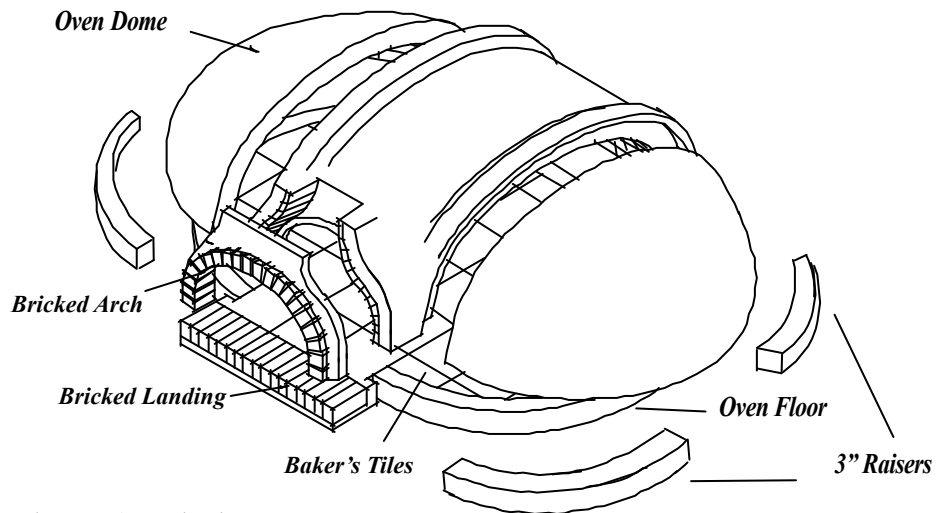

Smoke temperature :

For oven stoves : 347 °F or 175°C
Maximum temperature for the use of the oven :
1000 °F or 538 °C

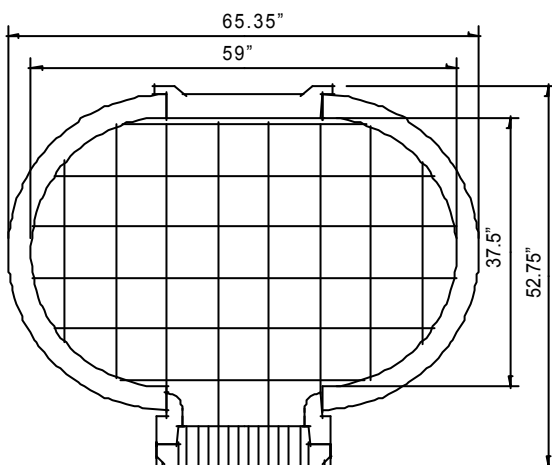
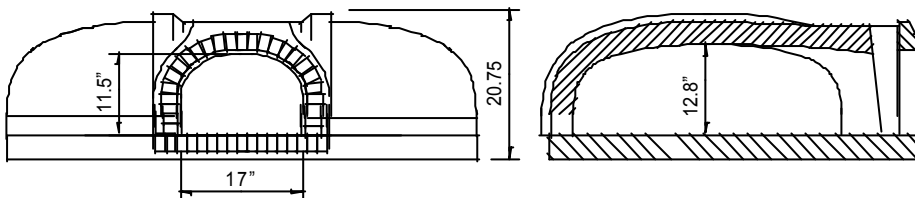

Included in the kit:

- Oven
- Insulated door
- Exterior cast iron door
- Flue connector with shut-off valve
- Vault thermometer
- Top and bottom insulation
- Assembly mortar
- Assembly instructions

Four "Grand Mere" for
Bread Stone Ovens, LLC - 2014
11140 Petal Street, Suite 250
Dallas, TX 75238